



ASSEMBLY AND INSTALLATION

INSTRUCTION

Please read carefully and save this instruction, as you may need them at a later date.

CAUTION

Turn off the main power at the circuit breaker before installing the fixture, in order to prevent possible shock. If you are unfamiliar with proper electrical wiring connections, please consult of a qualified electrician before installing

Installing Step:

Remove the fixture and the mounting package from the box and make sure that no parts missing in the box.

1. Use the Ball Nut (9) to fix the fixture on the wall tightly.
2. Put the Tube (6) onto the Socket (7) .
3. The Wood Bead (A) have been hung onto the hole of the Cap (1) and the other side hang it onto the above hole of the Metal Ring (2) ; The Wood Bead (B) have been hung onto the hole of the Metal Ring (3) and the other side hang it onto the below hole of the Metal Ring (2) ; Hang the Wood Bead (C) onto the holes of the Cap (4) , the Finial (5) and the Cap (8) .
4. Install bulbs: (Bulbs not including in the package)
(Please don't exceed the maximum capacity that recommended on the Sockets)

INSTALLATION IS NOW COMPLETED.

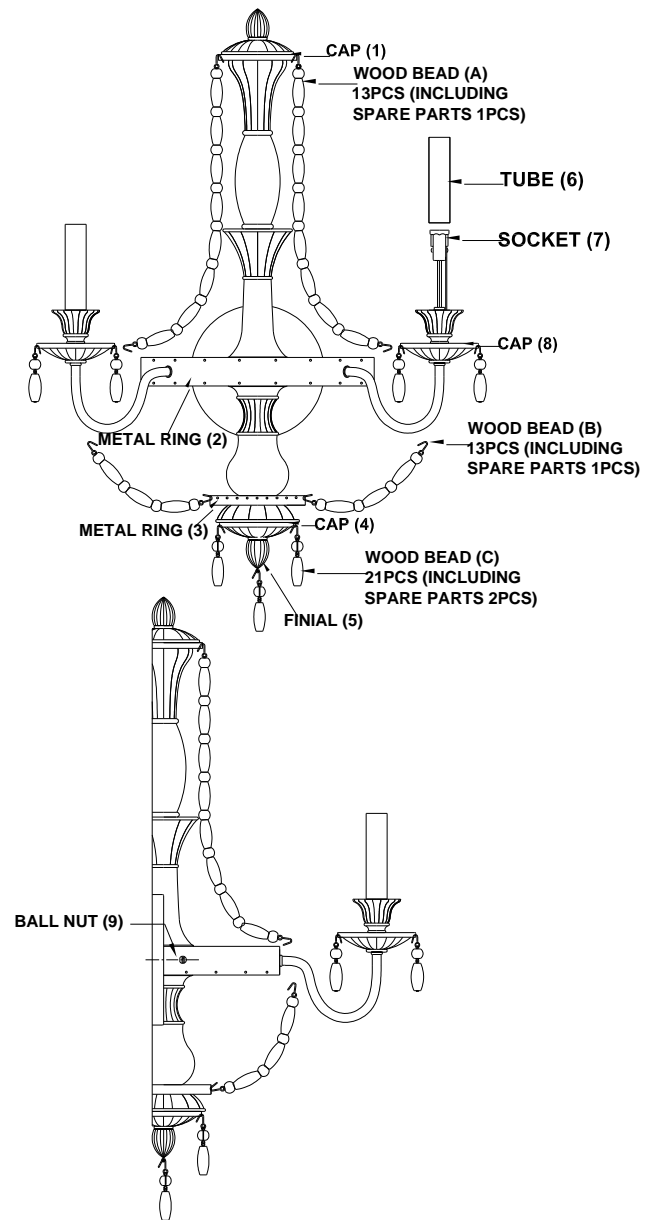

9-5092-2-82