

CRYST RAMA



1958

95 Cantiague Rock Road, Westbury NY 11590
 ph:516.931.9090 fax: 516. 931.1254
 info@crystorama.com www.crystorama.com

MODEL#:5119 ASSEMBLY AND DRESSING INSTRUCTIONS



All electrical components must be installed by a licensed electrician in accordance with the National Electric Code and the appropriate local electrical codes.

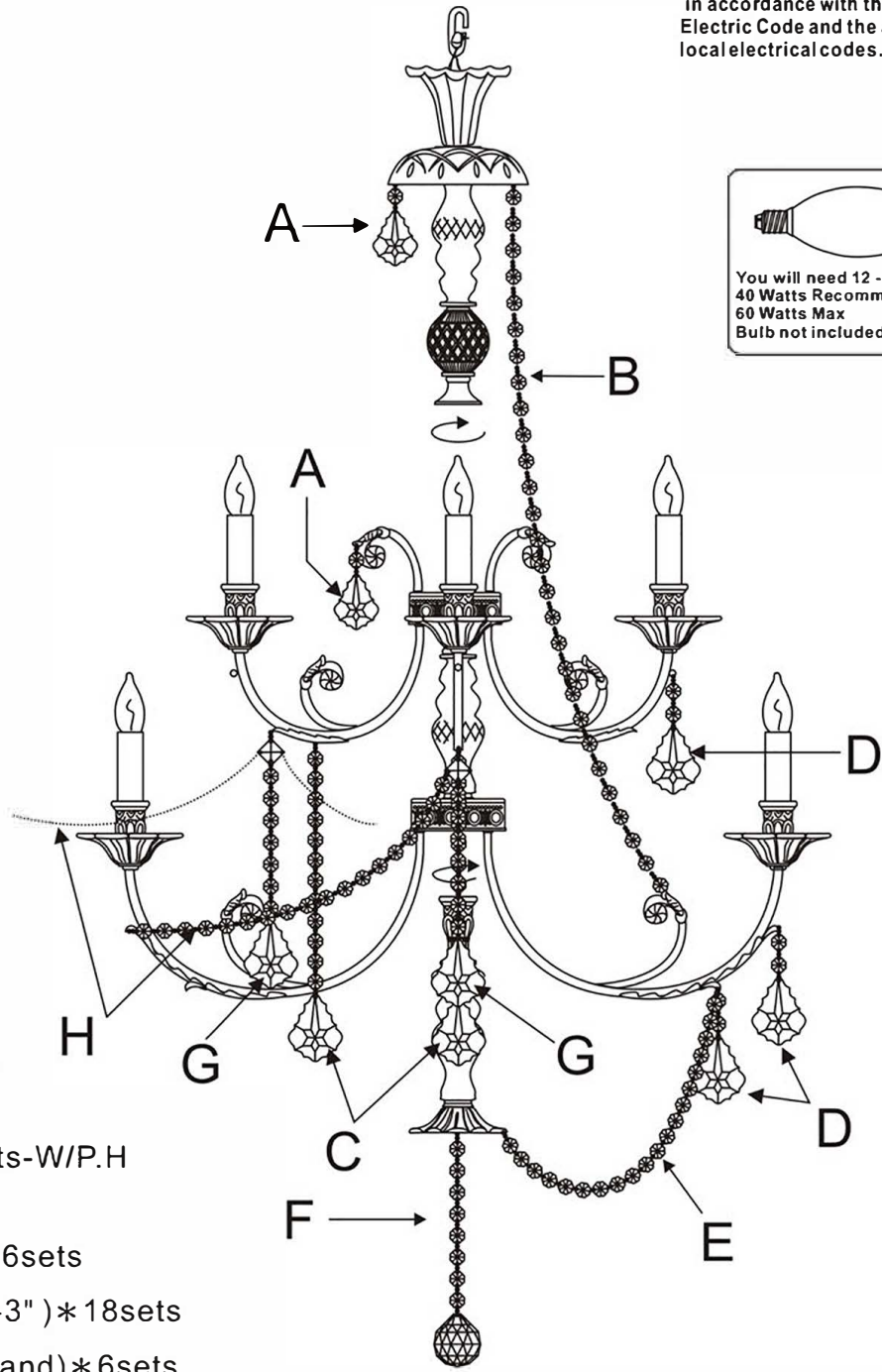
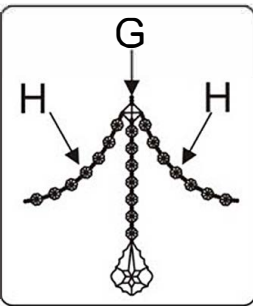
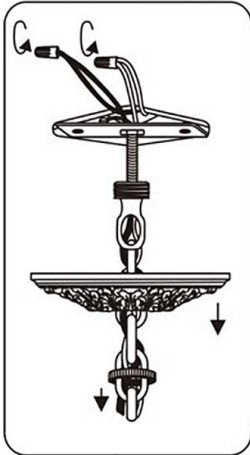
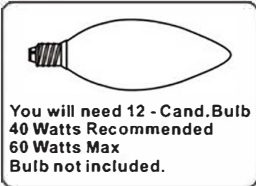

- A= (20/50-2") * 12sets
- B= (28 Jewels Strand) * 6sets-W/P.H
- C= (12 Jewels + 20/75-3") * 6sets
- D= (2 Jewels + 20/75-3") * 18sets
- E= (20 Jewels Strand) * 6sets
- F= (1x40mm Ball + 8 Jewels) * 1set
- G= (1 Square 4 Holes+ 7 Jewels + 20/75-3") * 6sets
- H= (18 Jewels Strand) * 12sets