

WAC LIGHTING

Low Voltage ME-826 LED MR16 Display Spot Light 3000K

Model & Wattage	Finish
ME-826 50W	BK Black
ME-826LED 8W	BN Brushed Nickel
	WT White

Example: **ME-826-BK**

DESCRIPTION

Single Spot Light with electronic transformer. Engineered with an integral transformer and designed for mounting to walls or ceilings, low and line voltage Display Spot Lights deploy optimal accent lighting from surface mounted canopies that can be custom designed with any of WAC low voltage track heads.

FEATURES

- Integral electronic transformer
- Accepts 12V LED MR16, Halogen MR16 lamps up to 50W max
- LED MR16 included when ordered as LED
- 1 watt minimum load
- Fixtures available with 6", 12", 18", 24", 36", and 48" extensions
- Special lens types such as spread lenses and UV lenses can be ordered from WAC and used in place of the supplied clear lens.
- Transformer concealed within the fixture
- 5 year warranty

SPECIFICATIONS

Construction:	Die cast Aluminum
Power:	50W, 8W
Input:	120 VAC, 50/60Hz
Dimming:	ELV: 100-10%
Light Source:	Halogen, Retrofit LED
Rated Life:	25000 Hours
Mounting:	Mounts directly to junction box, Can be mounted on ceiling or wall in all orientations
Finish:	Electrostatically Powder Coated Electroplated Black, Electroplated Brushed Nickel, Black, White
Operating Temp:	-4°F to 104°F (-20°C to 40°C)
Standards:	UL, cUL, Damp Location Listed

Fixture Type: _____
Catalog Number: _____
Project: _____
Location: _____



FINISHES

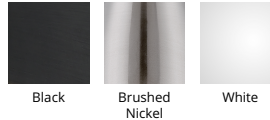

LINE DRAWING

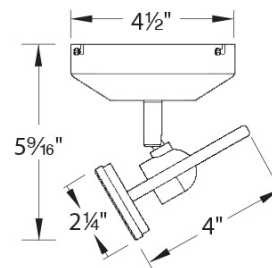

Fixture Type: _____

Catalog Number: _____





Project: _____

Location: _____

Low Voltage ME-826

LED MR16 Display Spot Light 3000K

ACCESSORIES

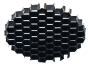
	<i>Model</i>	<i>Description</i>	<i>Finish</i>
	LENS-16-AMB LENS-16-BLU LENS-16-GRN LENS-16-RED	<i>Colored Lens</i> <i>Colored Lens</i> <i>Colored Lens</i> <i>Colored Lens</i>	<i>Amber</i> <i>Blue</i> <i>Green</i> <i>Red</i>
	LENS-16-FR	<i>Clear/Frosted Lens</i>	<i>Frosted</i>
	LENS-16-SPR	<i>Spread Lens</i>	<i>Spread Lens</i>
	LENS-16-UVF	<i>UV Filter lens</i>	<i>Clear</i>
	LENS-16-BEL	<i>Beam Elongating Lens</i>	<i>Beam Elongating</i>
	LENS-16-HCL	<i>Honeycomb Louver</i>	<i>Black</i>