

All dimensions are shown in inches unless otherwise stated.

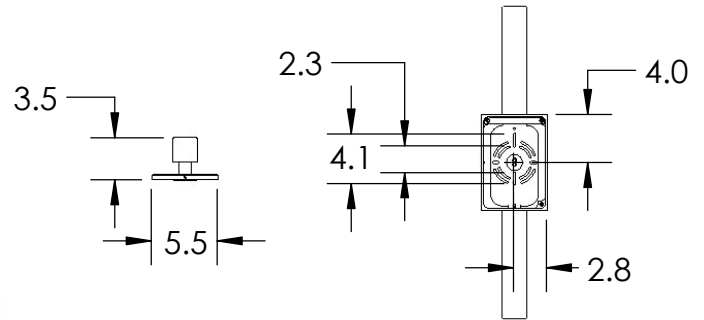
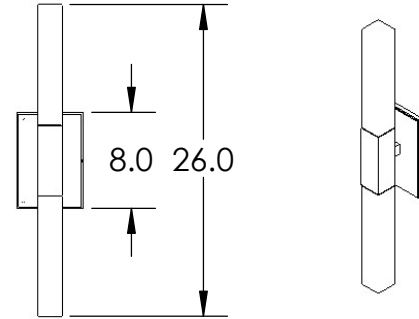

Mounting Method: J-Box Wall Mount

PRODUCT DESCRIPTION

A slim wall lighting solution that suits both modern and transitional interiors, this 26" tall sconce features two thick rods of LED-lit artisan cast glass, with metalwork detail and backplate. A sparkling layer of recycled glass, brilliantly repurposed from Hammerton's glass blowing operations, adds visual interest. Offered in a choice of eight finishes. ADA Compliant.

PRODUCT SPECIFICATION

Construction: Aluminum Body With Cast Glass

Finish Options: **FB** **GB** **GM*** **HB*** **MB** **BS** **RB*** **SN***

Glass Options: Cast Glass

Suspension Method: Wall Mount

Weight(lbs.): 11

UL Rating: Dry

Top Diffuser: Closed Glass

Bottom Diffuser: Closed Glass

Light Source: LED

Electrical Qty: 2

Wattage (Watts):6

Voltage (Volts): 120

Source Lumens: 466

Dimming: Forward/Reverse Phase to 1%

CCT: 2700K or 3000K

Driver Quantity & Location: 1, in J-Box

CRI: 93+

Power Factor: >0.9

*Coastal Metallic options are available upon request, and required for installations located within 10 miles of the ocean.

SCAN FOR MORE INFORMATION

Notes:

GENERAL NOTES:

Visit studio.hammerton.com to read our Lifetime Limited Warranty.

This product may use mixed materials like steel and aluminum in its construction. Translucent finishes may vary between steel and aluminum.

All Hammerton fixtures are handcrafted by artisans. Subtle imperfections reflect the mark of the artisan and should be expected in any handcrafted product. Dimensions may vary up to 7/8".

Rev (A) 8/16/2021