

Trade Mark:
CRYSTAL WORLD INC

Product Name: Wall lamp
Model :5320W24C
120Vac, 60Hz,AC ONLY
Lamp Size:W24"*H5"*E5"

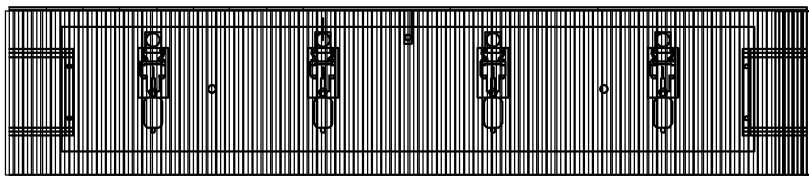

WALL LAMP ASSEMBLY INSTRUCTIONS

1. Place fixture(A) onto mounting screws (DD).secure with cap nuts (AA).

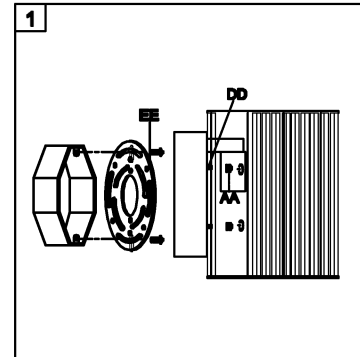

Hardware Used

AA Cap nut		X 2
DD Mounting screw		X 2

2. Please hang the crystal(1) to the fixture .

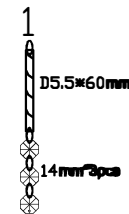

16PCS

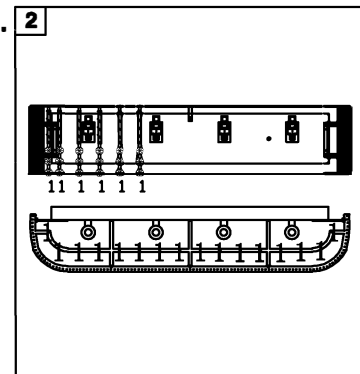

3. Install light bulbs (not included).

Use bulb
120V G9  4*40W Max.

