

Tools Required

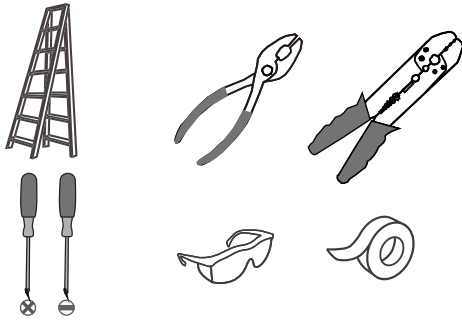

Light Source

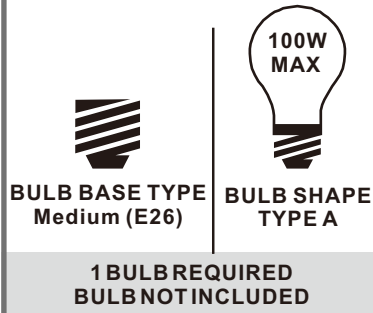

**Fixture Height Adjustable
10.5" to 46.5"**

⚠ Warnings and Cautions

Turn off the electricity at the circuit breaker before installation. Consult a licensed electrician if in doubt about installation.

Turn off power to the fixture and allow the bulbs to cool before replacing.

Package Contents

Preparation: Identify and inspect all parts before beginning the installation.

Missing or damaged parts? Contact your original place of purchase.

PARTS BAG

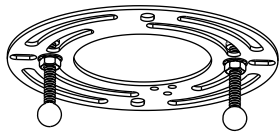

A Crossbar Assembly
x 1



B Outlet Box Screw
x 2



C Wire Connector
x 3

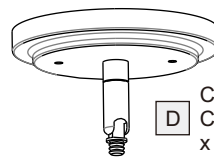

D Ceiling
Canopy
x 1

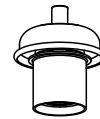

G Fixture
Body
x 1



E 6"L Rod
x 2

F 12"L Rod
x 2

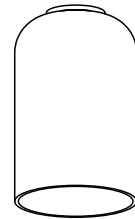

H Shade
x 1

Table of Contents

Crossbar Assembly

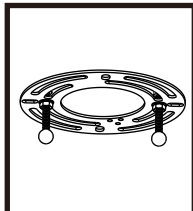

STEP 1

Downrod



STEP 2

Wiring

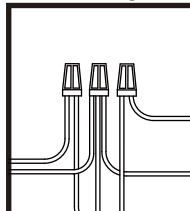

STEP 3

Ceiling Canopy

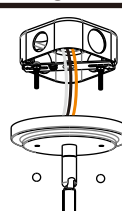

STEP 4

Shade & Bulb



STEP 5

STEP 1

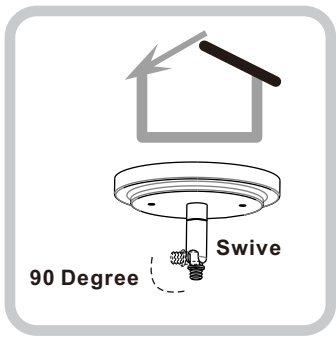

For angled ceilings, Swivel opening towards wall.

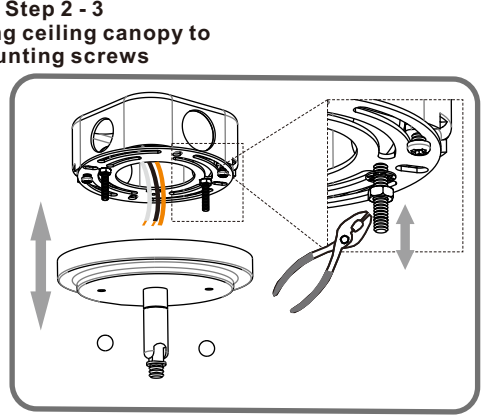
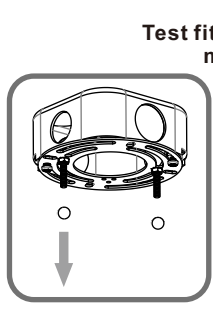
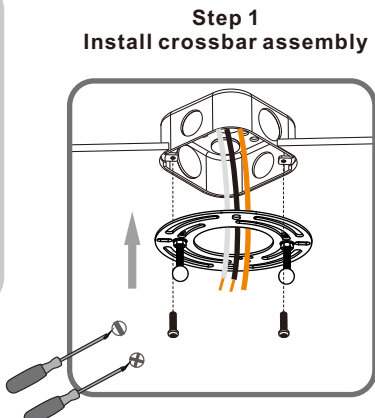

STEP 2

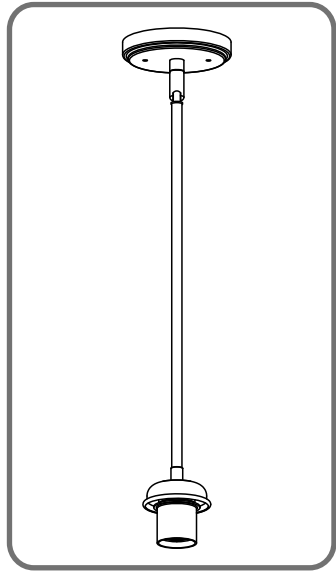
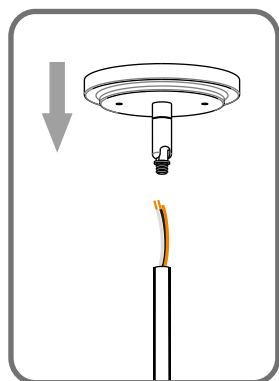
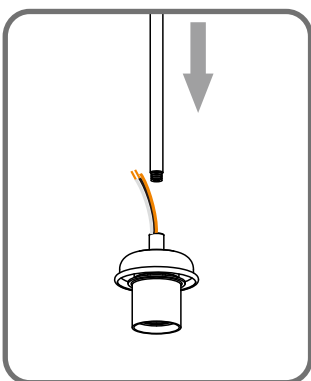
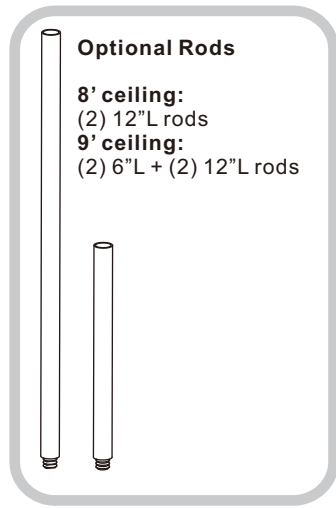

STEP 3

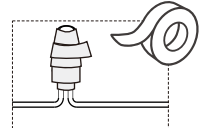
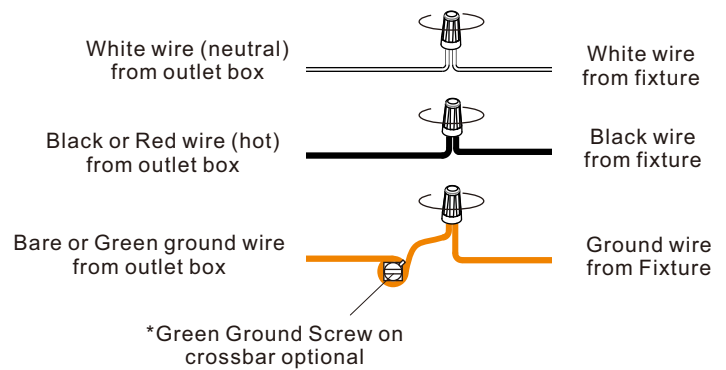

STEP 4

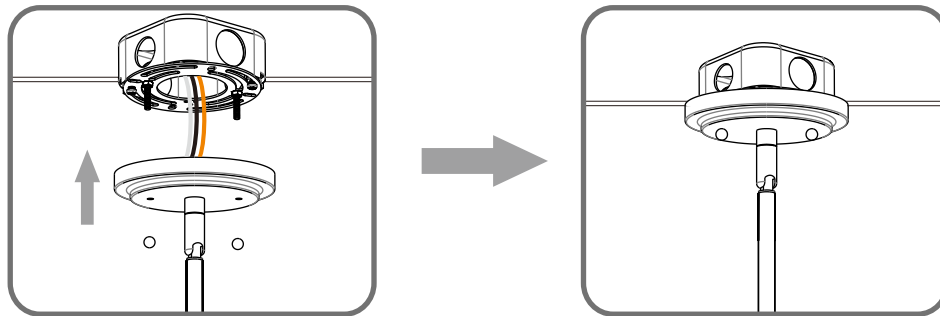

STEP 5

