

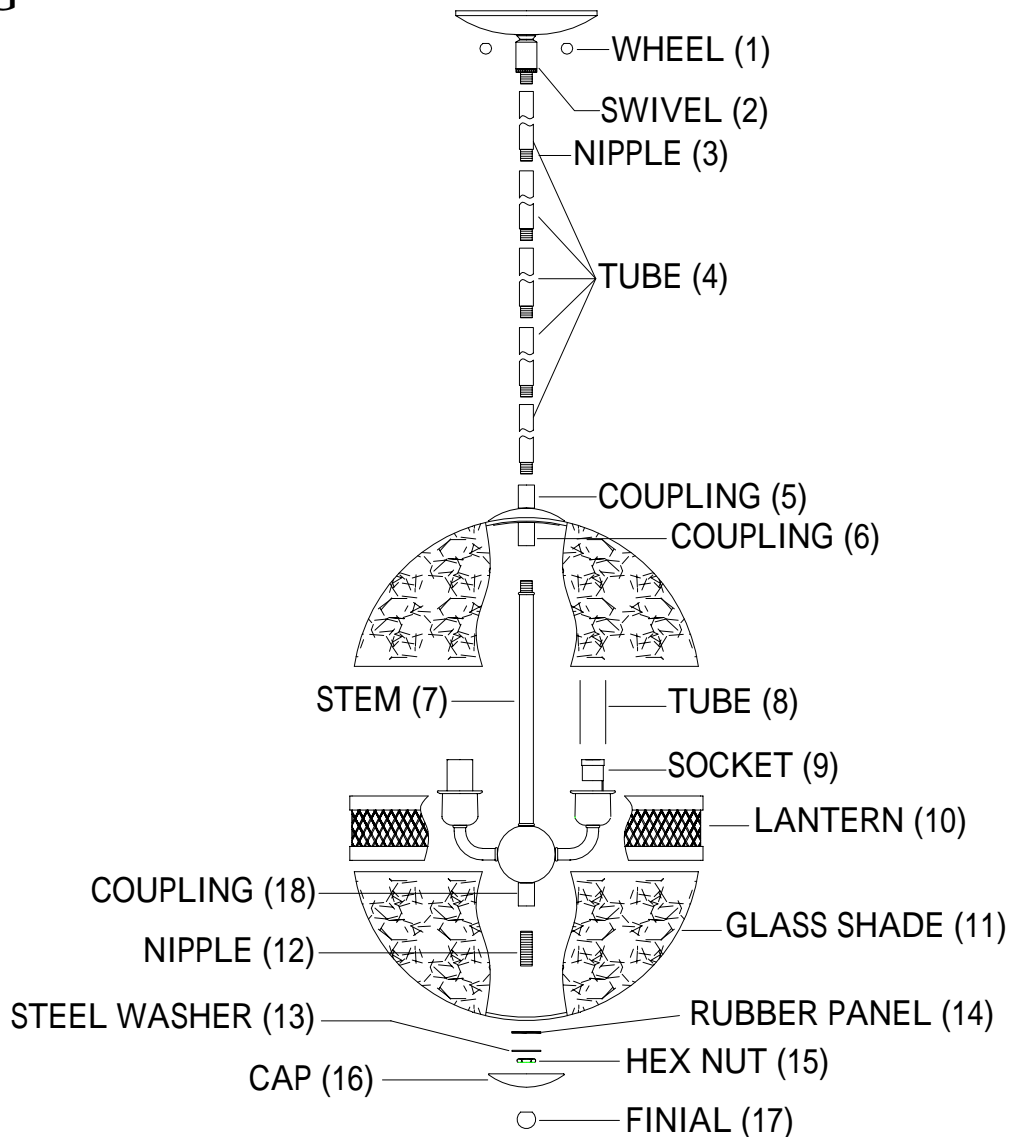

ITEM NO: 7-200-3-57  
7-200-3-322

## LIGHTING



### INSTALLATION INSTRUCTIONS

1. Carefully remove the fixture out of the carton, and check that all parts are included referring to the above illustration. Make sure not to misplace any parts that are needed for the installation;
2. Assemble the tube (4) together using the nipple (3), then attach the bottom end of tube (4) onto the coupling (5) tightly, then secure the swivel (2) onto the tube (4).
3. Install the stem (7) into coupling (6), then secure them with stem (7).
4. Install the tube (8) and bulb (NOT INCLUDED) into socket (9).
5. Install the lantern (10) onto glass shade (11).
6. Install the nipple (12) into coupling (18), then secure them with nipple (12).
7. Install the glass shade (11), rubber panel (14) and steel washer (13) onto nipple (12), then secure them with hex nut (15).
8. Install the cap (16) onto nipple (12), then secure them with finial (17).
9. Fixture is ready for lamping and installation.