

Collection: AXIS

Product #: PLB0060-3T

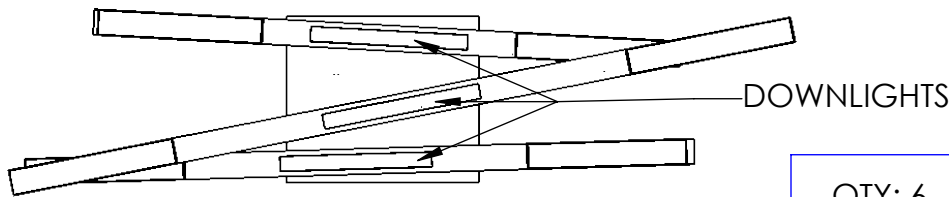

QTY: 6 - CLEAR TEXTURED CAST GLASS

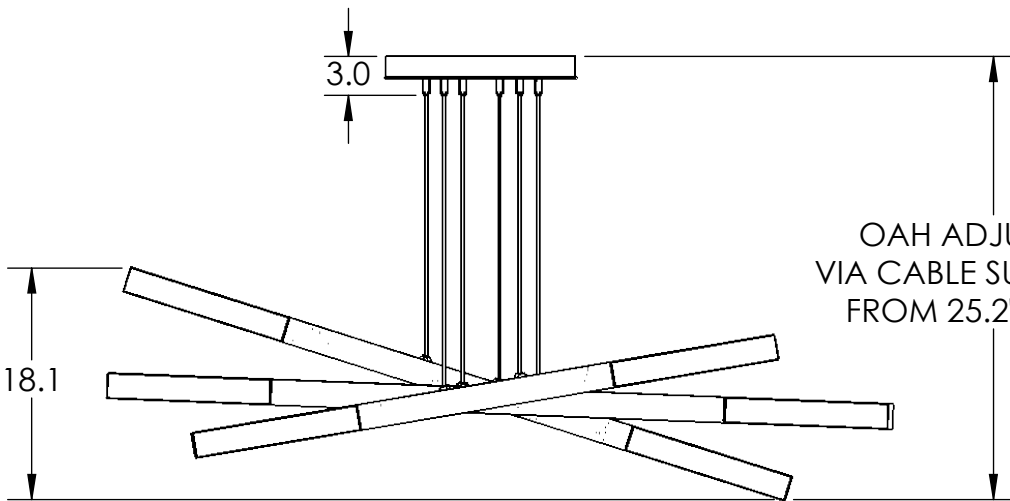
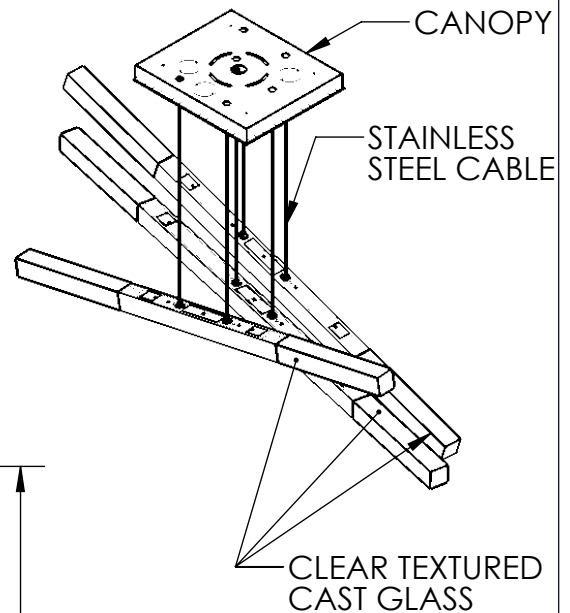
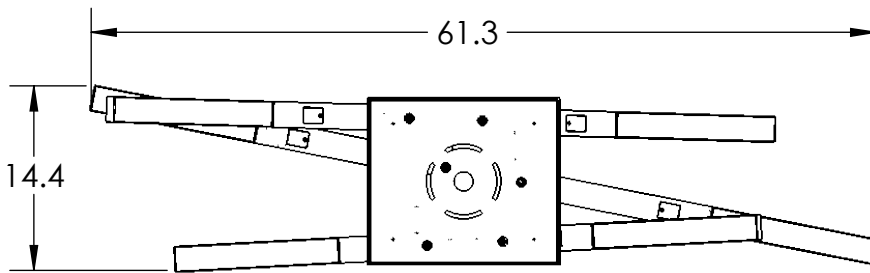
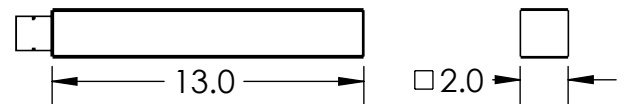

All dimensions are shown in inches unless otherwise stated. Visit [hammeronstudio.com](http://hammeronstudio.com) for product options.

8/6/2021 (B)

Mounting Packet: R	Weight(lbs.): 63	Electrical Type: LED	CCT: 2700/3000K
UL Location: DRY	Elec. Qty: 18	Wattage: 48	Voltage: 120
Finish: SEE WEB SITE FOR OPTIONS	Source Lumens: Ambient:4197	Down:2798	
Top Diffuser: N/A	Dimmable: Forward/Reverse Phase to 1%		
Bottom Diffuser: Frosted Acrylic	CRI: 93+	Power Factor: >0.9	

Canopy Mounting Detail

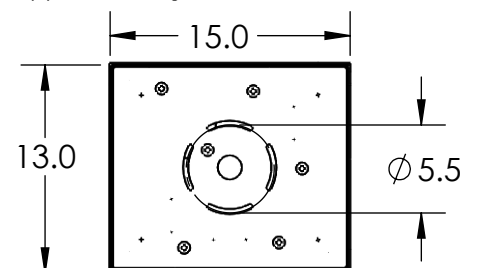

MOUNTS TO BUILDING STRUCTURE

All Hammerton fixtures are handcrafted by artisans. Subtle imperfections reflect the mark of the artisan and should be expected in any handcrafted product. Dimensions may vary up to 7/8".  
 © Copyright 2021. All rights in design, detail or invention of this drawing are reserved as the property of Hammerton. Any imitation or adaptation without written consent is strictly prohibited.