

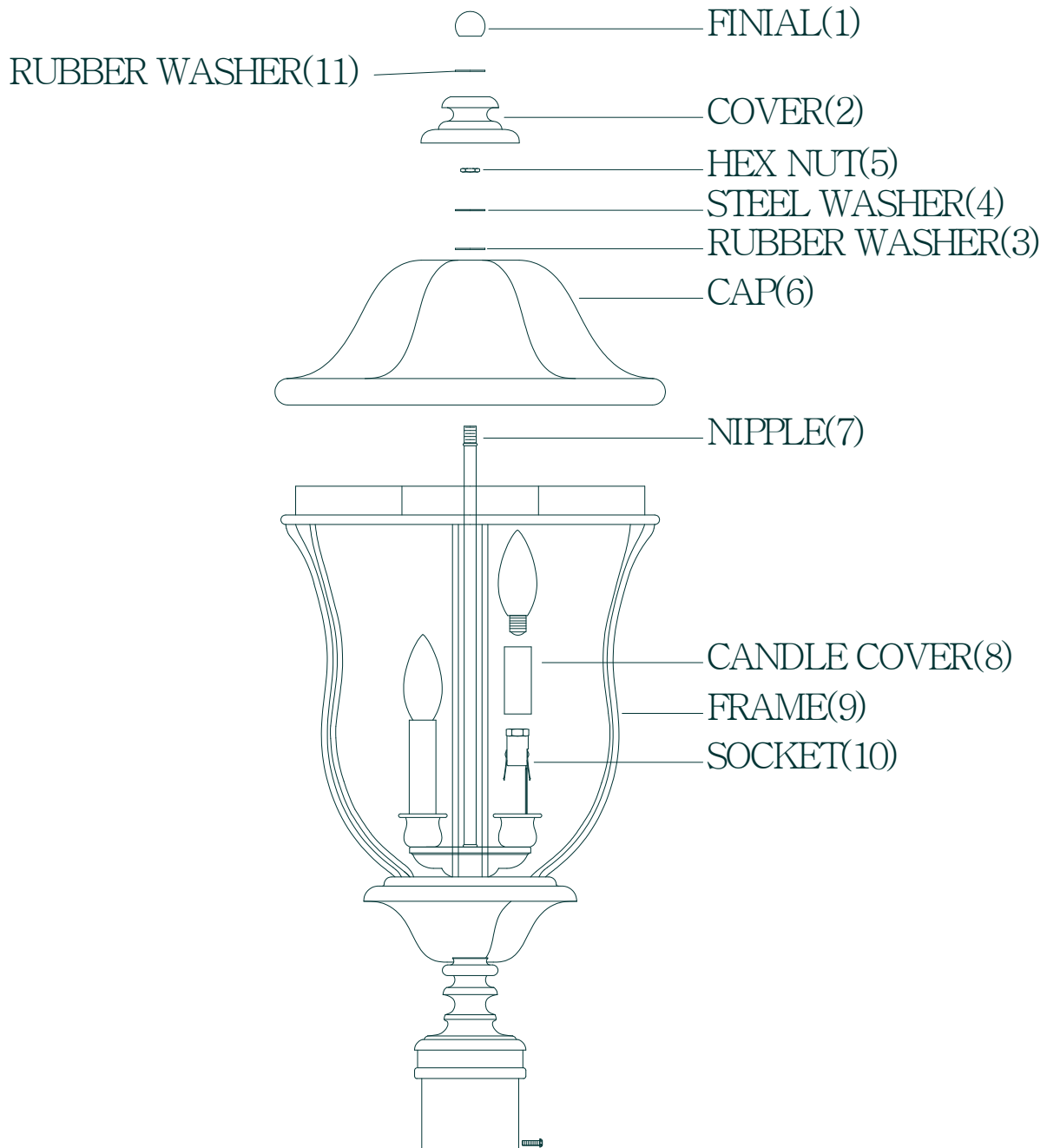

## LIGHTING



### INSTALLATION INSTRUCTIONS

1. Carefully remove the fixture out of the carton, and check that all parts are included referring to the above illustration. Make sure not to misplace any parts that are needed for the installation;
2. Slide the candle cover(8) onto the socket(10), then install the lamps on;
3. Thread the hex nut(5) onto the proper position of the nipple(7) , then slide the steel washer(4), rubber washer(3), cap(6),cover(2) ,rubber washer(11)onto the nipple(7) in order, secure them with finial(1);
4. The fixture is assembled!