

ASSEMBLY INSTRUCTIONS

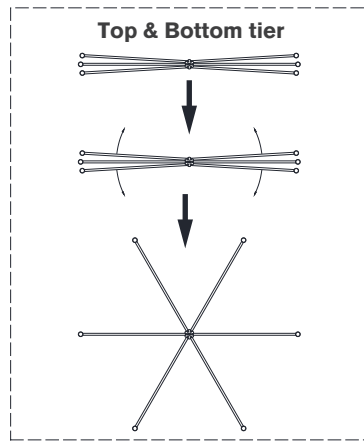
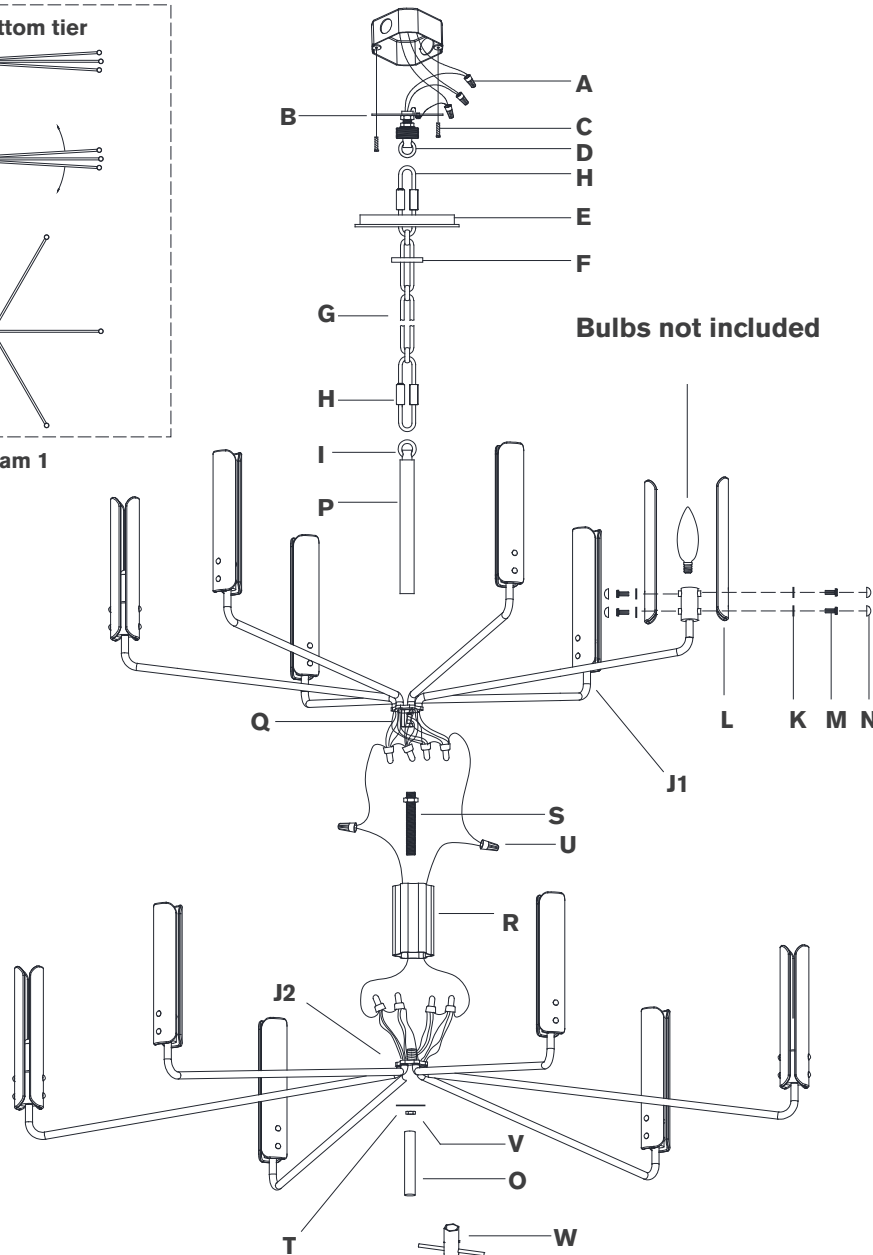

Diagram 1



Bulbs not included

Casoria Grande Two Tier Chandelier

Item # ARN 5486

NOTICE:

This light fixture should be installed in accordance with all applicable, local installation codes, and by a person familiar with the construction and operation of it, as well as the hazards involved. Inspect item and contents carefully. If any damage or defect is found, do not install. Retain all packaging material until installation is complete and approved.

TOOLS REQUIRED (NOT INCLUDED):

Phillips Screwdriver	Slotted Screwdriver	Chain Pliers
Slip Joint Pliers	Measuring Tape	Wire Cutters
Wire Strippers		

PERSONS REQUIRED: Two

1. Carefully remove all parts from the box. Place on a clean, soft surface.
2. Rotate fixture arms into position as shown in diagram 1, spacing each arm evenly for top & bottom tiers.

NOTE: If needed, tighten hex nuts on arms using provided wrench (**W**). See diagram 2.

3. Remove collar loop (**D**) from chain (**G**) by unscrewing quick link (**H**).
4. Install mounting plate (**B**) to junction box and secure with mounting screws (**C**).
5. Secure collar loop (**D**) to mounting plate (**B**) using pliers to tighten locknut.
6. Install canopy (**E**) to collar loop (**D**) by securing and secure with collar ring (**F**).
7. Determine desired overall length, and amount of chain (**G**) needed. Shorten chain using chain pliers. (Keep extra chain)
8. Feed fixture wire and ground wire through tube (**P**) and connect to top tier (**J1**).
9. Attach chain (**G**) to collar loop (**D**) and to fixture loop (**I**) using quick links (**H**). Secure quick links (**H**).
10. Install threaded tube (**S**) to hickey (**Q**) using pliers to tighten locknut.

NOTE: It is recommended to have a helper assist in supporting the fixture for steps 11-14.

VISUAL COMFORT



ASSEMBLY INSTRUCTIONS

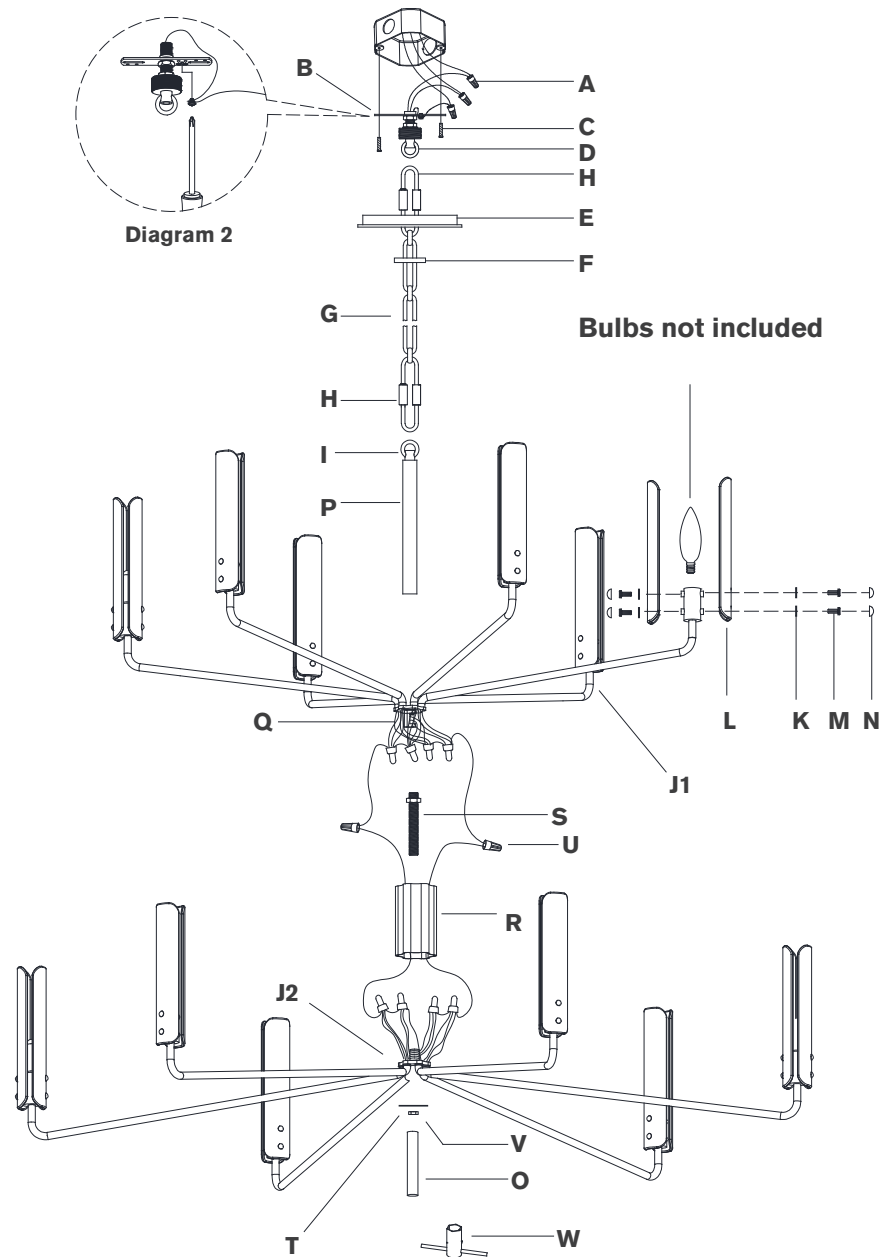

Casoria Grande Two Tier Chandelier

Item # ARN 5486

NOTICE:

This light fixture should be installed in accordance with all applicable, local installation codes, and by a person familiar with the construction and operation of it, as well as the hazards involved. Inspect item and contents carefully. If any damage or defect is found, do not install. Retain all packaging material until installation is complete and approved.

11. Feed fixture wires from bottom tier (**J2**) through hub (**R**).
12. Connect top tier neutral wire (ribbed) to bottom tier neutral wire (ribbed) using wire nut (**U**).
13. Connect top tier hot wire (smooth with markings) to bottom tier hot wire (smooth with markings) using wire nut (**U**).
14. Install hub (**R**) and bottom tier (**J2**) to threaded tube (**S**) and secure with metal washer (**T**) and hex nut (**V**) using provided wrench (**W**).
15. Thread finial (**O**) to the bottom of tier (**J2**).
16. Thread fixture wire and ground wire through chain (**G**).
NOTE: When you reach the collar loop (**D**), ensure there is no tension on the wires. Cut excess wires, being sure to leave enough to reach the junction box.
17. Separate two sides of molded wire, and strip insulation on each 5/8".
18. Loosen collar ring (**F**) and let canopy (**E**) slip down chain (**G**) carefully.
19. Twist all fixture wires together. Slip through center hole of collar loop (**D**).
NOTE: Untwist wires and separate to prepare for connection.
20. Wrap fixture ground wire (bare copper) around the green grounding screw (see diagram 2). Tighten. Continue fixture ground wire and connect to supply ground wire (usually green or bare copper) using wire nut (**A**).
NOTE: It is imperative that the fixture is grounded.
21. Connect fixture neutral wire (ribbed) to the supply neutral wire (usually white) using wire nut (**A**).

ASSEMBLY INSTRUCTIONS

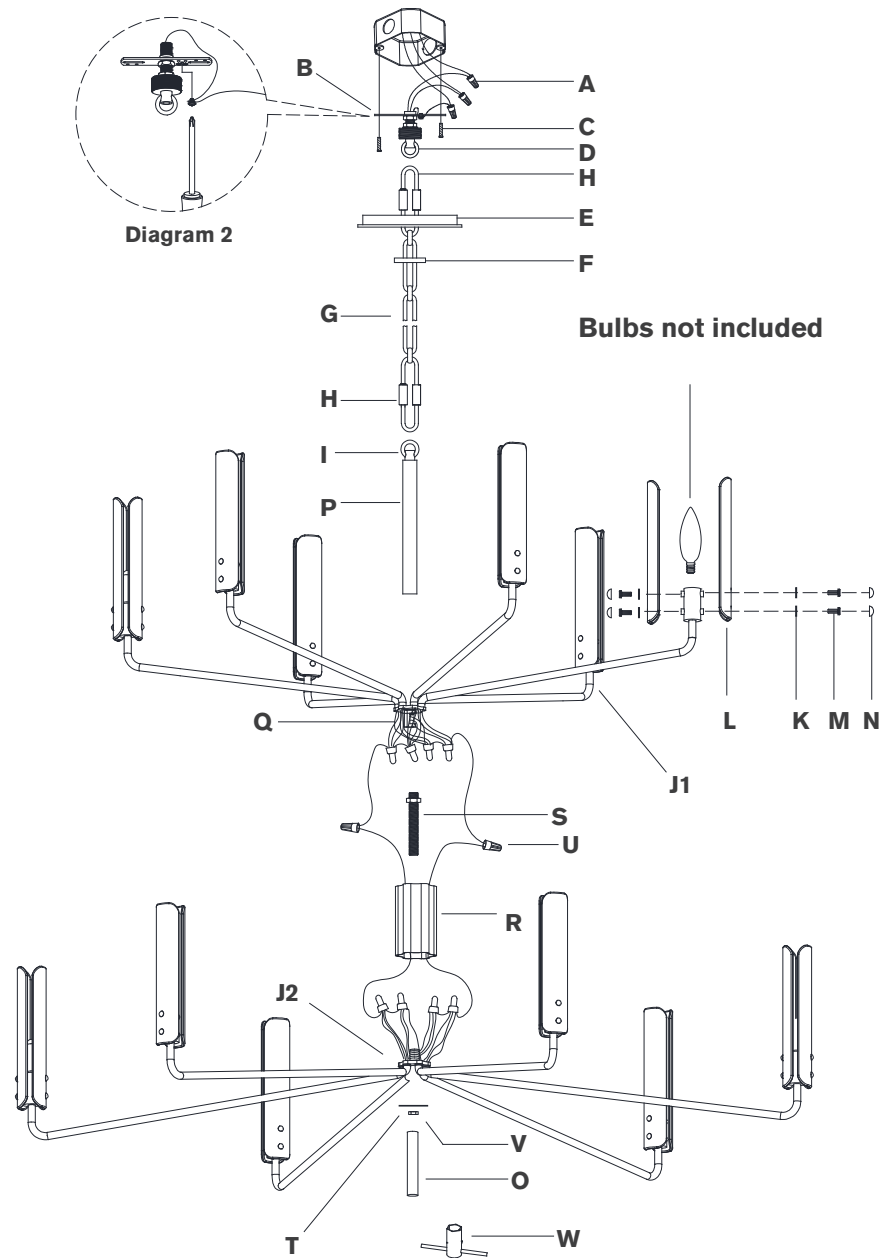

Casoria Grande Two Tier Chandelier

Item # ARN 5486

NOTICE:

This light fixture should be installed in accordance with all applicable, local installation codes, and by a person familiar with the construction and operation of it, as well as the hazards involved. Inspect item and contents carefully. If any damage or defect is found, do not install. Retain all packaging material until installation is complete and approved.

22. Connect fixture hot wire (smooth with markings) to the supply hot wire (usually black) using wire nut **(A)**.
CAUTION: Do not reverse the hot and neutral connections.
23. Make sure all wire connections are tight, then carefully tuck into the junction box.
24. Install canopy **(E)** to collar loop **(D)** and secure with collar ring **(F)**.
25. Install light bulbs into the sockets.
27. Attach glass panels **(L)** and rubber washers **(K)** to socket cup and secure with screws **(M)** and caps **(N)**.
NOTE: Do not overtighten otherwise glass could become damaged.

Care Instructions: Clean only with a soft dry cloth or feather duster. Do Not use abrasive or chemical agents.