

**Tools Required**

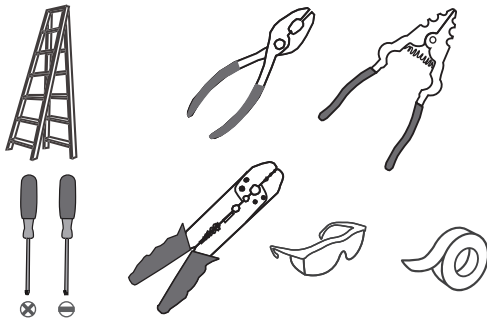

**Light Source**

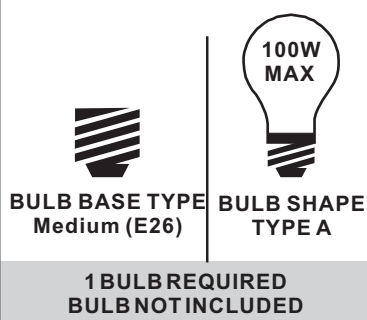

**Fixture Height Adjustable  
10.25" to 46.25"**

**Warnings and Cautions**

Turn off the electricity at the circuit breaker before installation. Consult a licensed electrician if in doubt about installation.

Turn off power to the fixture and allow the bulbs to cool before replacing.

**Package Contents**

**Preparation:** Identify and inspect all parts before beginning the installation.

Missing or damaged parts? Contact your original place of purchase.

**PARTS BAG**

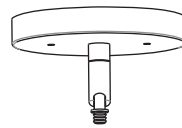
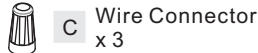
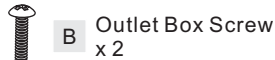
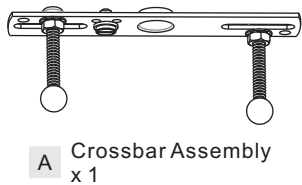

D Ceiling Canopy x 1

H Shade (Varies according to style purchased) x 1

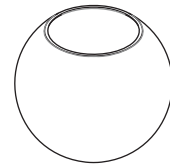
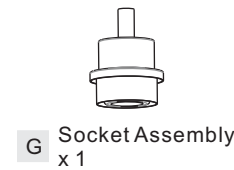

**Note:** Shade shape is for illustration purpose only. Your shade shape may vary from illustration.

**Table of Contents**

**Crossbar Assembly**

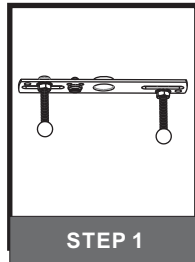

STEP 1

**Downrod**

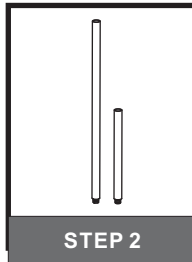

STEP 2

**Wiring**

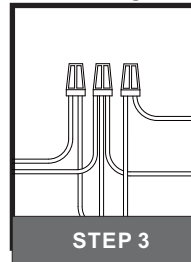

STEP 3

**Ceiling Canopy**

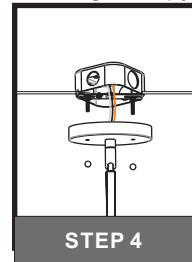

STEP 4

**Shade & Bulb**

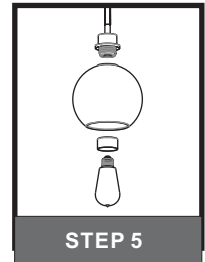

STEP 5

## STEP 1

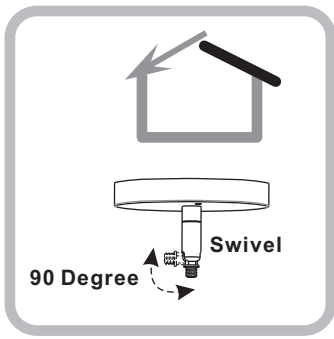

For angled ceilings,  
Swivel opening towards wall.

1

Step 1  
Install crossbar assembly

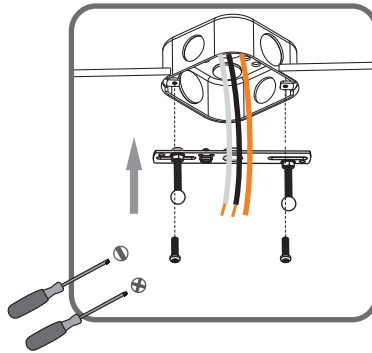

2

Step 2 - 3  
Test fitting ceiling canopy to  
mounting screws

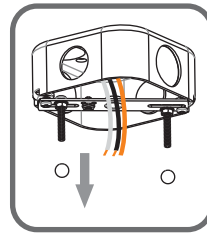

3

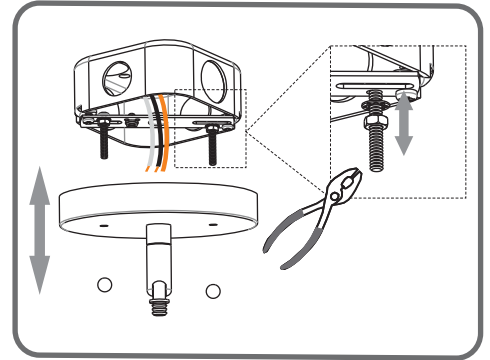

## STEP 2

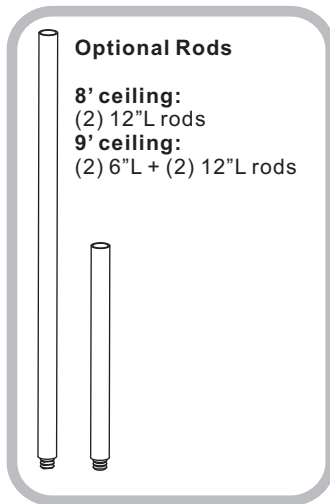

1

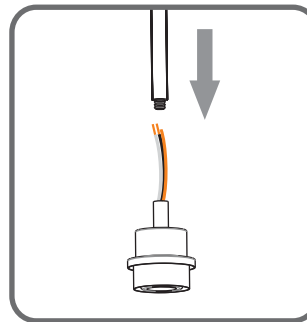

2

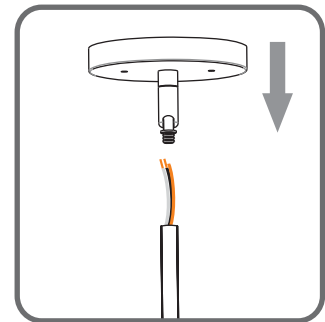

## STEP 3

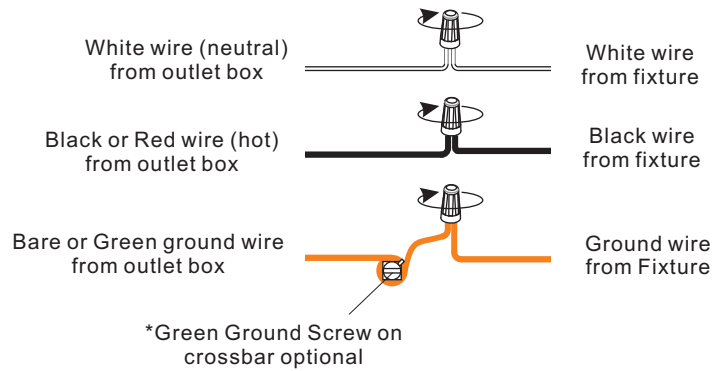

**STEP 4**

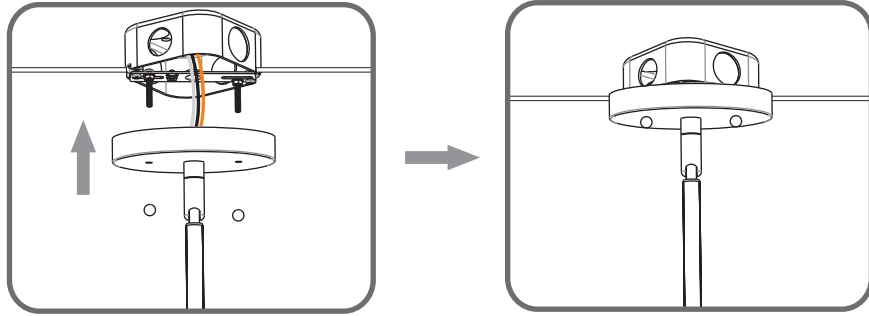

**STEP 5**

1

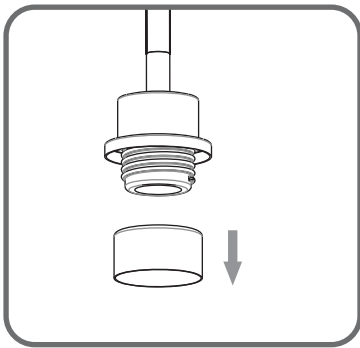

2

**Note: Shade shape is for illustration purpose only. Your shade shape may vary from illustration.**

