

# Assembly Instructions For F2478/6 (E) 11/09

	1	2	3	4	5	6	7	8	9	Extra PIN Qty.	PIN PART	PIN DESCRIPTION
										12		S Hook
Required	X7	X3	X3	X6	X6	X24	X6	X6	X1	6		Bowtie pin
Extra	1		1		1	6	1	1	1	6		Head Pin

## IMPORTANT TURN OFF THE POWER AT THE MAIN FUSE OR CIRCUIT BREAKER BOX BEFORE STARTING INSTALLATION

Carefully unpack and identify all parts before assembly.  
Bulbs not included.

- Turn arms so they are equally spaced apart from each other.
- Slip small notched cover and fixture loop through fixture wires.
  - Install the small notched cover on top of fixture, making certain arms are locked onto its notches, by fastening with fixture loop.
  - Install a hex nut onto one end of short threaded pipe leaving about 3/8" (10mm) of thread exposed. Then install same end of pipe by screwing onto bottom of fixture. Tighten hex nut.
  - Slip large notched cover through the installed threaded pipe and secure by fastening with finial. Make certain arms are locked onto its notches before tightening finial.
- Follow enclosed supplement installation instructions for electrical and fixture installation onto house outlet box. If you do not have an outlet box at desired location to attach the fixture then hire a qualified electrician to create one.  
**IMPORTANT: WHEN FOLLOWING SUPPLEMENT INSTRUCTIONS STEP #6, MAKE CERTAIN TO SLIDE CRYSTAL BOBECHE (IN BETWEEN COLLAR RING AND CANOPY) DOWN THE CHAIN.** See above illustration.
- Install crystal bobecche by slipping through sockets.
  - Install candle tube by slipping through sockets.
  - Install type-B, candelabra base, of 60 Watt maximum bulbs (not included).
- Hang all crystal glass parts as shown on drawing.  
**NOTE:** To replace broken crystal or pin, extras are included in hardware bag. Replace by gently bending open pin, remove broken crystal or pin, hook new one, then close back pin. Avoid bending pin into sharp angle.

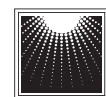
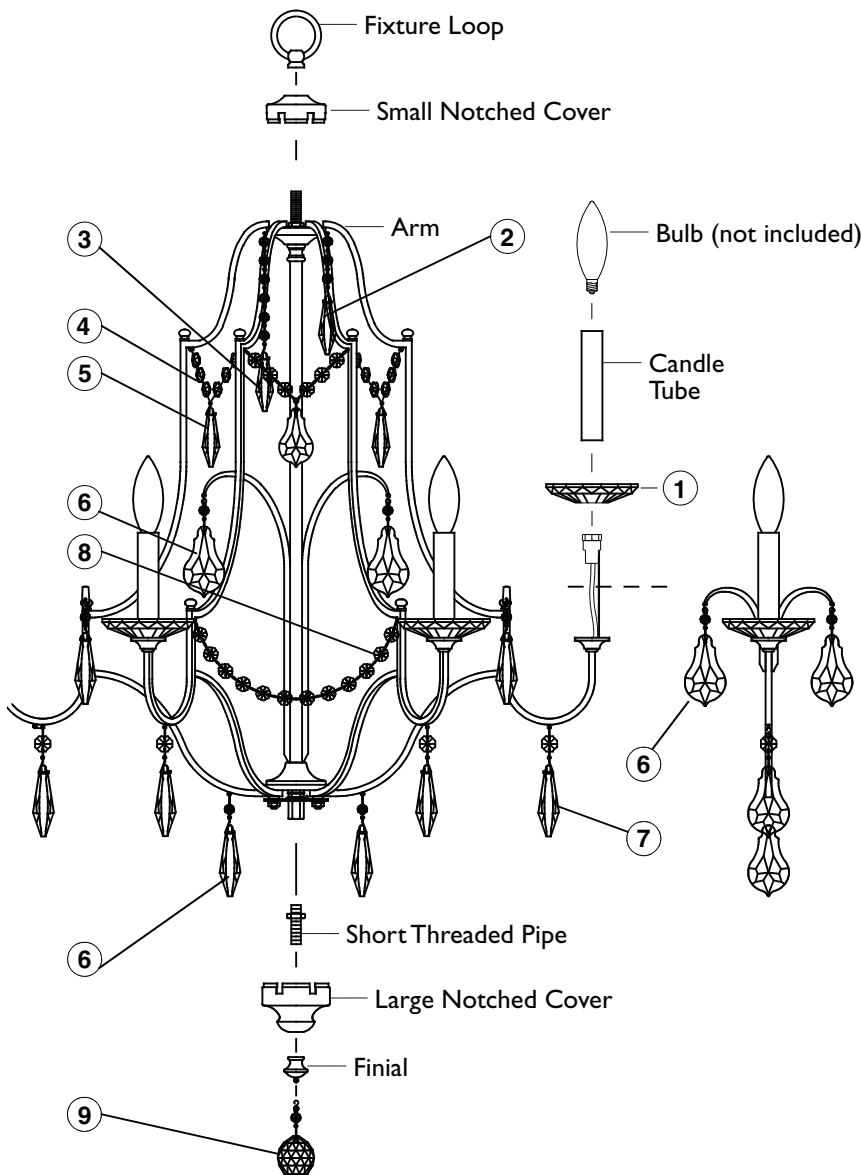

**MURRAY  
FEISS**

GENERATION  
BRANDS